

DO NOT SCALE

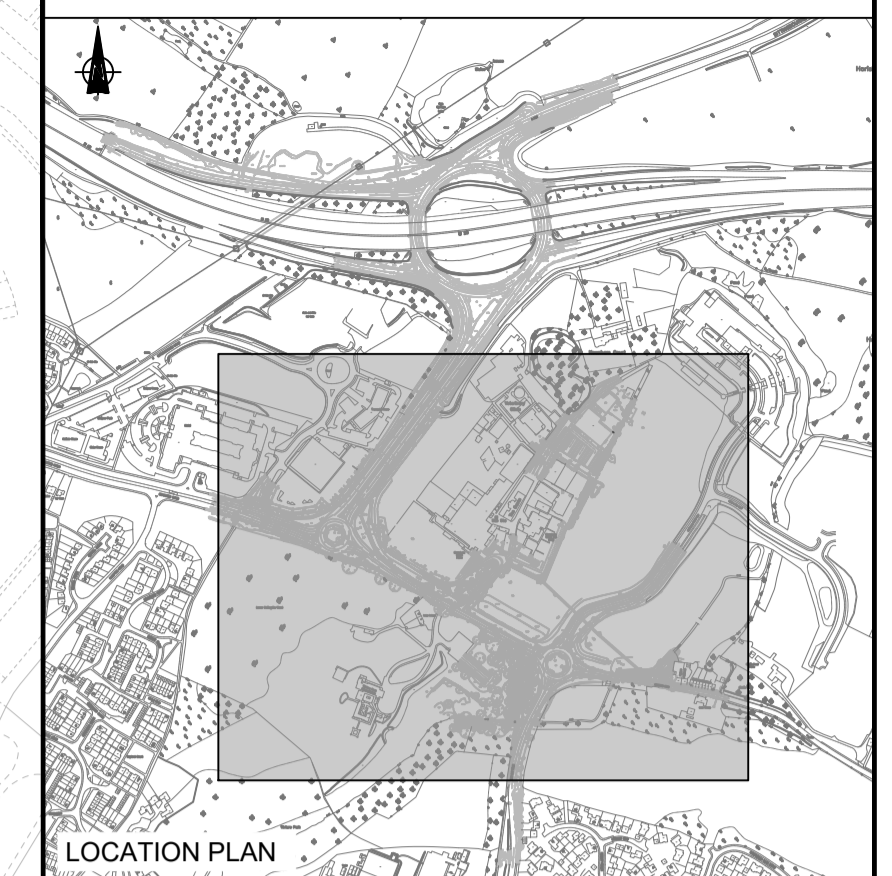

- NOTES:
1. ALL DIMENSIONS ARE IN METRES UNLESS STATED OTHERWISE.
 2. THIS DRAWING IS NOT TO BE REPRODUCED IN ANY PART OR FORM WITHOUT CONSENT OF WSP. ALL COPYRIGHT RESERVED.
 3. DRAWING TO BE PRINTED IN COLOUR.
 4. THE LOCATION AND DEPTH OF ALL EXISTING SERVICE APPARATUS SHOULD BE CONFIRMED PRIOR TO COMMENCING ANY EXCAVATION WORK.
 5. THE EXTENT OF SHARED FOOTWAY/CYCLEWAY ALONG NEW CUT ROAD IS YET TO BE FINALISED.

- KEY:
- PROPOSED DESIGN
 - CARRIAGEWAY
 - NON PEDESTRIAN ISLAND/HARD LANDSCAPING
 - VERGE
 - EARTHWORK
 - SHARED FOOTWAY/CYCLEWAY
 - FOOTWAY
 - OTHER PAVED AREAS
 - RETAINING WALL
 - SWALE/LAGOON

INSERT 'B'
FOR CONTINUATION SEE
DRAWING NUMBER 70040984-SK-0086

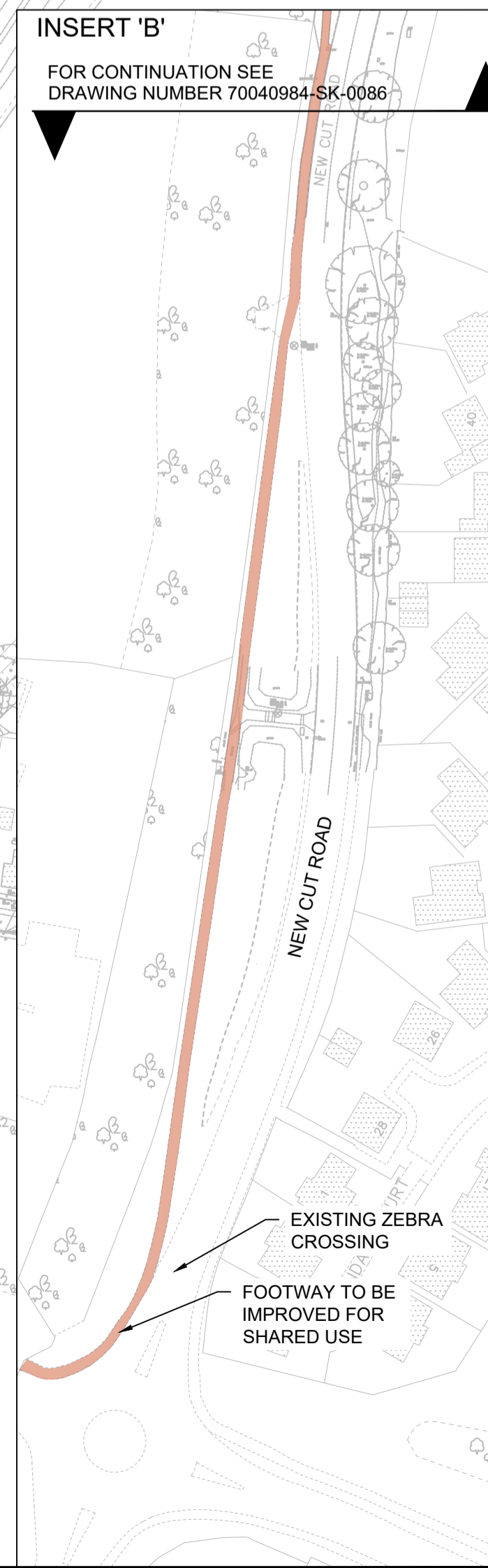

REV	DATE	BY	DESCRIPTION	CHK	APP
P01	21/02/2022	RA	ISSUED FOR DISCUSSION	JH	DC

DRAWING STATUS: FOR DISCUSSION ONLY



4th Floor, 6 Devonshire Square, London, EC2M 4YE, UK
T+ 44 (0) 207 337 1700, F+ 44 (0) 207 337 1701
wsp.com

CLIENT: Kent County Council
1st Floor, Invicta House, Maidstone, ME14 1XX



SITE PROJECT: KENT MEDICAL CAMPUS TO M20 J7 IMPROVEMENTS

TITLE: BEARSTED ROAD DUALLING FULL EXTENT PLAN

SCALE @ A1: 1:1000	CHECKED: JH	APPROVED: DC
PROJECT NO: 70040984	DESIGNED: RA	DRAWN: RA
DRAWING NO: 70040984-SK-0086	DATE: 21/02/2022	REV: P01

© WSP UK Ltd

File name: C:\USERS\WSP\001\DOCUMENTS\WSP\PROJECTS\02_MCR\DRAWINGS\02_DRAWINGS\IN PREPARATION\70040984-SK-0086_P01.DWG, printed on 21 February 2022 17:32:12, by All Right

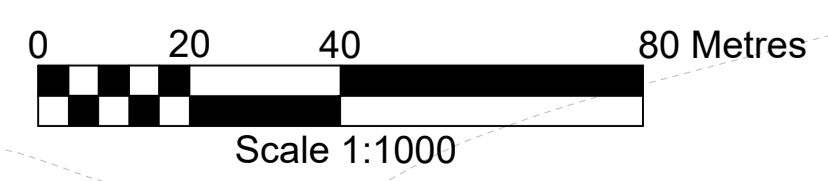

© Crown Copyright and database right 2022. Ordnance Survey 100019238